



Reference: BLG26058

October 24, 2011

Mr. Keith Hodgkins
Onsite Engineering Services Ltd.
P.O. Box HM2170
Hamilton HMJX
Bermuda

Dear Mr. Hodgkins

**Shore Cliff Inspection
Grand Atlantic Development
South Shore Road
Warwick, Bermuda**

The above site was visited on October 20, 2011 to make a visual examination of the shore cliff and confirm that the remedial measures have been carried out in accordance with our report dated October 29, 2009.

At the time of the site visit, the western part of the shore cliff was remediated. The area examined is shown on Drawing 1. The entire base of the cliff is protected by a concrete wall which prevents erosion of the sand layer previously noted. All vegetation has been removed from the cliff and the cliff has been scaled of all loose pieces of rock. These conditions are shown on Photos 1 to 3.

One sand pocket was noted in the middle of the cliff (see Photo 4). This was not showing signs of erosion and may form a hard dark crust with time. This sand pocket should be periodically monitored and if erosion occurs then it should be covered with a protective stone and concrete facing.

One large sand pocket is present at the top of the cliff as shown on Photo 5. It is understood that this will be benched and that a retaining wall will be constructed at this location.

Based on the site visit, the shore cliff in the western part of the site has been remediated as per the recommendations of our report. Periodic inspections should be carried out to confirm that the slope remains in its present stable condition. If any loose rock forms due to weathering or deleterious plants start to grow in the cliff face or at the top of the cliff, then these should be removed as required.

We trust this report is satisfactory for your purposes. Should you have any questions, please do not hesitate to contact this office.

Yours truly,
Lohse Geoconsulting Inc.



Holger Lohse, P.Eng.
I have the authority to bind the corporation





Photo 1: West End of Shore Cliff



Photo 2: Central Part of Shore Cliff



Photo 3: Eastern Part of Shore Cliff

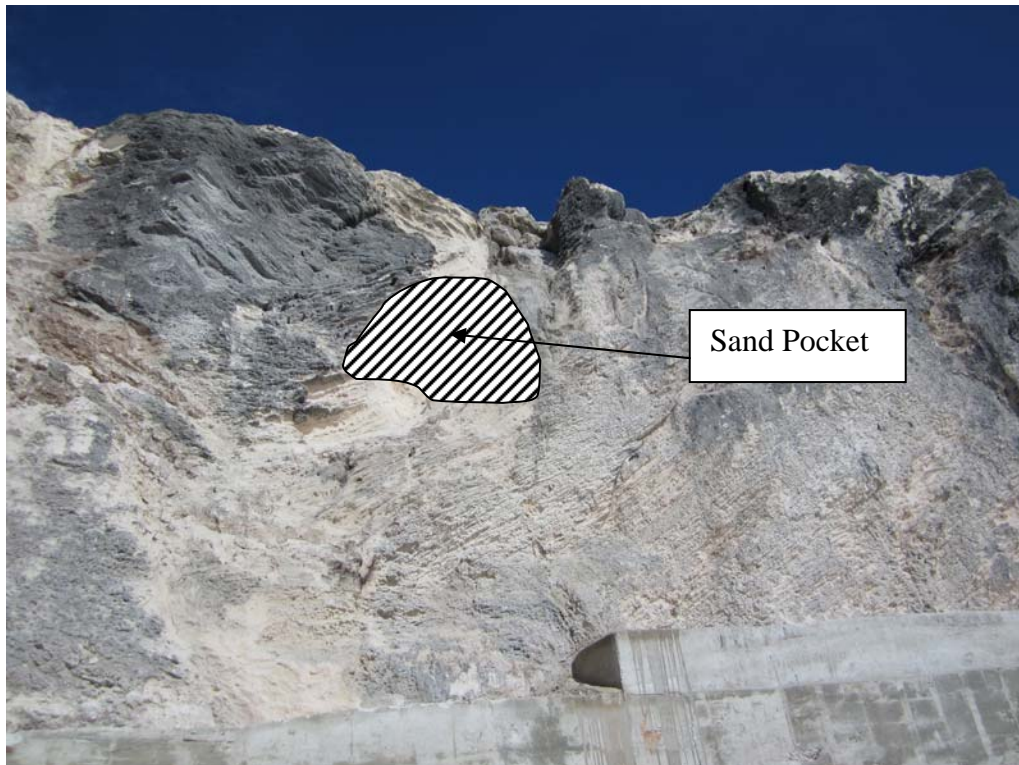
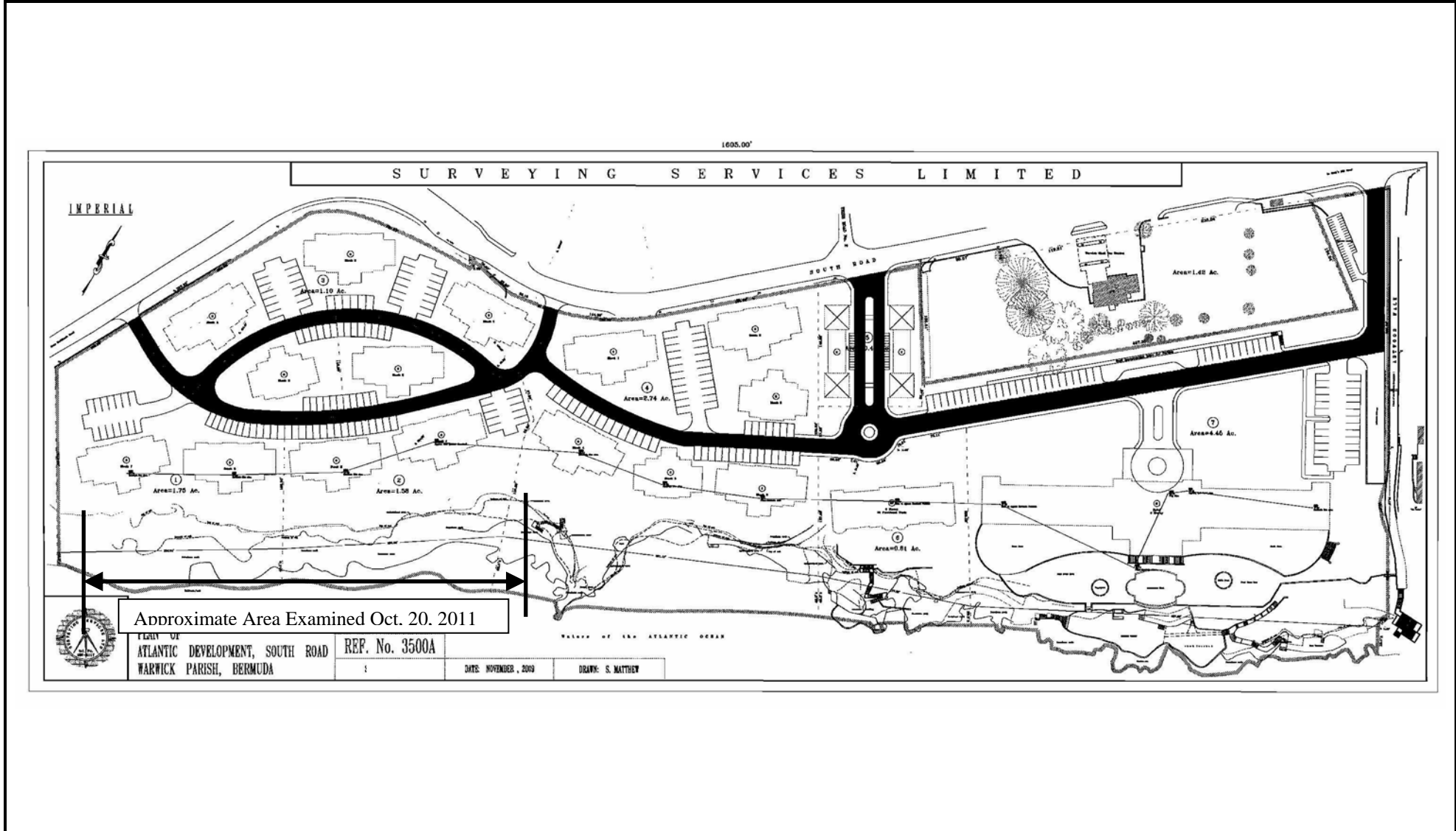

Photo 5: Sand Pocket



Photo 6: Sand Pocket at Top of Cliff



Atlantic Development
 South Shore Road
 Warwick Parish, Bermuda

Site Plan
 (not to scale)

Drawing 1