

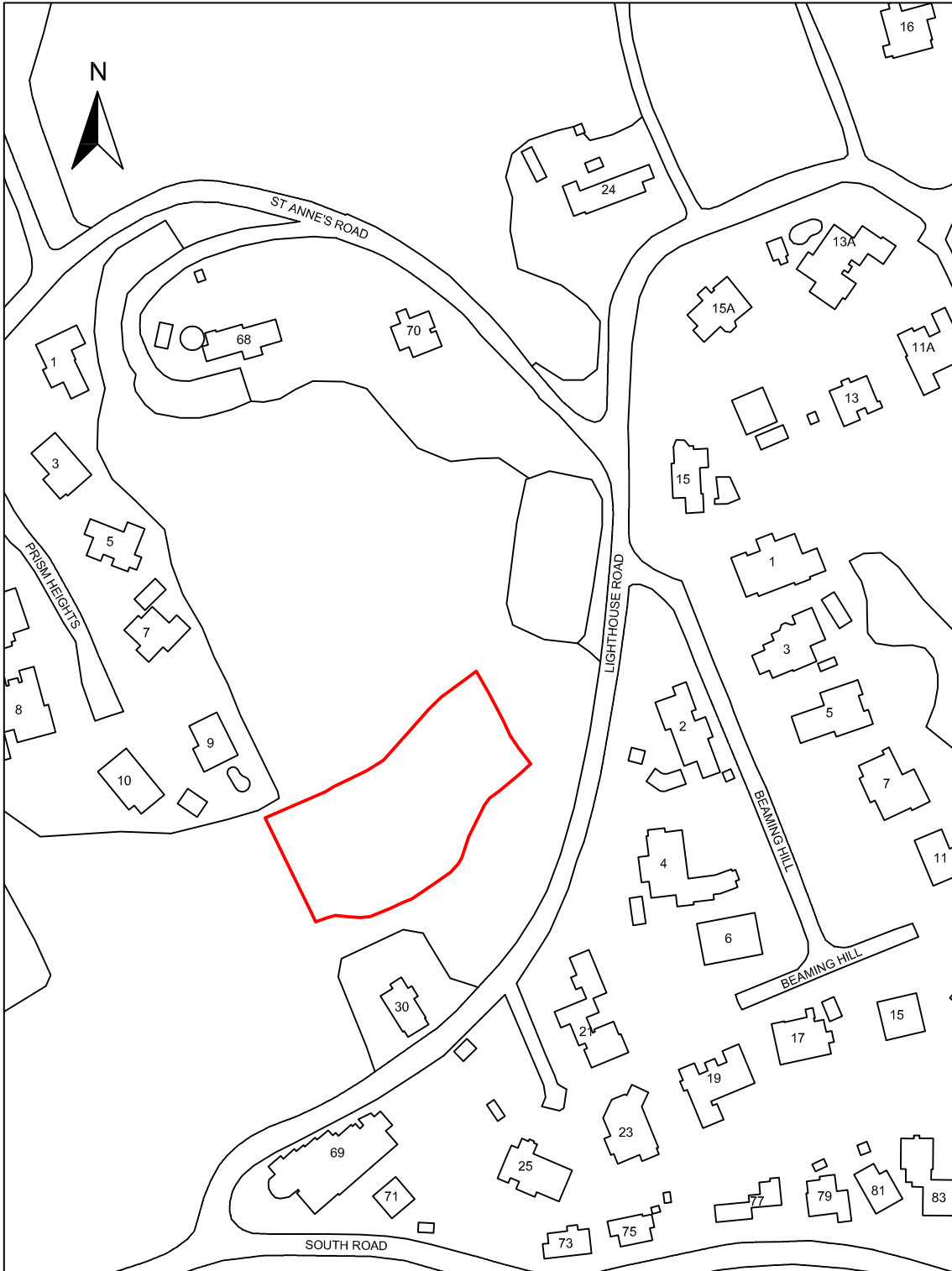

GOVERNMENT OF BERMUDA  
Ministry of Public Works

*Lease Plan*



**Arable Land at Gibbs Hill Lighthouse, Lighthouse Road, Southampton**

Date: December 2015  
Scale: 1:2000

Drawing No. 5510/046/453  
File No.

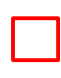
 Approximate Area = 0.502 ha (0.785 acres)  
For identification purposes only